



AIRGLOW

Dear reader,

A warm welcome to AirGlow, the shining domain of Gyrex!

We cordially invite you to explore our world of innovative GRG solutions in the lighting and ventilation industry. Browse through our brochure and discover the possibilities of AirGlow.

With AirGlow you get high-quality elements that are both functional and aesthetically pleasing. Our easy-to-install product offers excellent strength and durability.

Every day we strive for solutions that perfectly meet your unique requirements. Discover our customization and see how we can bring your vision to life.

Enter the world of AirGlow and experience limitless creativity and quality.

We look forward to welcoming you soon.

Yours sincerely,

A handwritten signature in black ink, appearing to read 'KM', is positioned above the name and title of the sender.

Kristof Monsieurs
CEO

1

The origin

Airglow was developed from the need for a solution that integrates lighting and ventilation without aesthetic concessions. Traditional systems with visible ventilation grilles and separate lighting fixtures did not meet modern requirements. That is why Airglow offers sleek, modern lighting that is easy to install and at the same time ensures optimal air circulation. This eliminates unsightly extraction nozzles from ceilings and creates a harmonious, functional design.

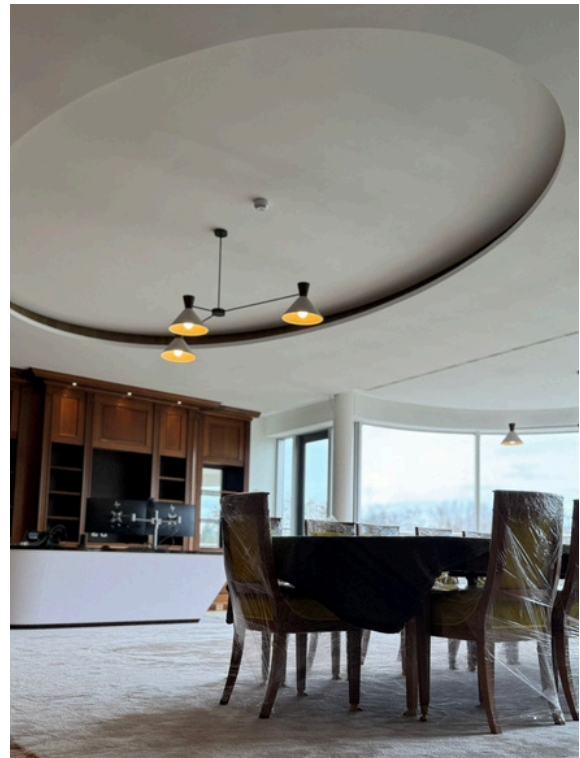

Our products are designed with an eye for detail, ease of use and durability, allowing architects, designers and installers to create beautiful, efficient spaces. Discover the possibilities with Airglow for stylish and functional projects.



2

Product benefits

Our expertise lies in manufacturing exclusive and elegant lighting elements with the special properties of Gyrex-GRG, making limitless possibilities a reality.

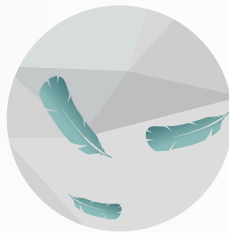

Lighter than classic plaster



Non-flammable with fire reaction class A1



Solution for complex details



dimensionally stable and impact resistant



Fast installation



Seamless connection with plasterboard or plaster

3

Gamma

These elements are designed for a wide range of applications ranging from residential and commercial to industrial environments. Airglow strives to provide lighting solutions that are efficient, reliable and sustainable.

Benefits of Standard Lighting Components from Gyrex

Durability and Long Lifespan: Airglow products are known for their robust construction and long lifespan. This means less frequent replacement and maintenance, which is cost effective in the long run.

Quality Consistency: Gyrex follows strict quality controls and manufacturing processes to ensure that every lighting component meets high standards. This guarantees reliable and consistent light output in every application.

Ease of use: Gyrex lighting systems are designed with the user in mind. They are easy to install and maintain, which improves the overall user experience and reduces the time and effort required for installation and maintenance.

Aesthetic Value: In addition to functionality, Airglow also offers aesthetically attractive lighting solutions. Their products are designed to not only perform, but also to be visually appealing, adding to the overall look of the room.

Due to these benefits, Airglow standard lighting components deliver reliable and efficient lighting solutions that meet the demands of modern lighting projects. They combine energy efficiency, durability and ease of use with high aesthetic value, making them an excellent choice for a wide range of applications.

AirGlow Square

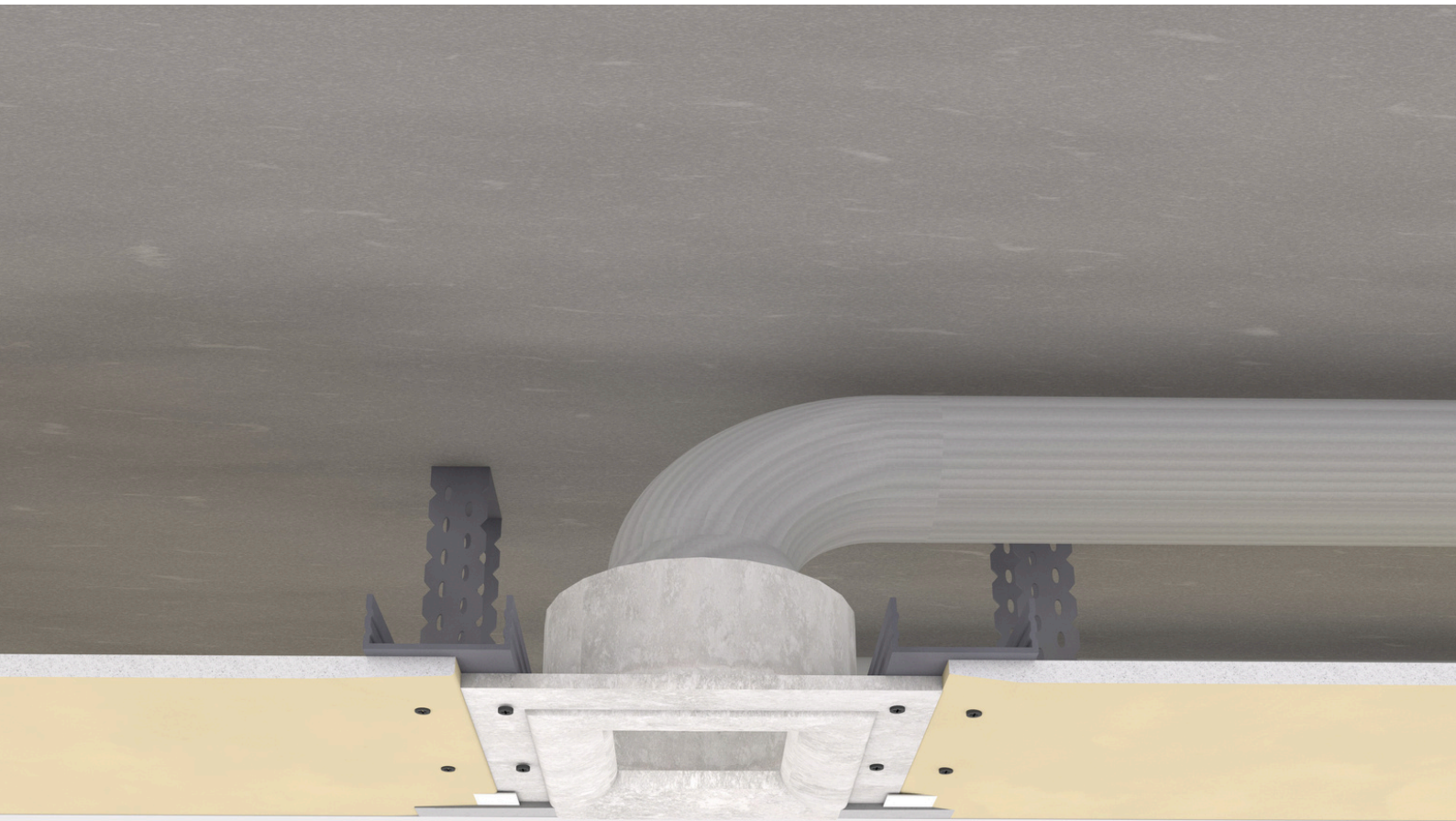

Discover the Airglow SQUARE, an innovative square lighting fixture with invisibly integrated ventilation. This design combines sleek aesthetics with functionality, eliminating the need for ceiling vents.

The Airglow SQUARE creates a seamless look in any space, while providing optimal lighting and air circulation. Ideal for architects and designers who do not want to compromise on style and efficiency.

The Airglow SQUARE is compatible with any type of air duct, including fixed, flexible air duct or valve collectors, ensuring versatility.

We can offer these with accompanying spotlights, ask for more information

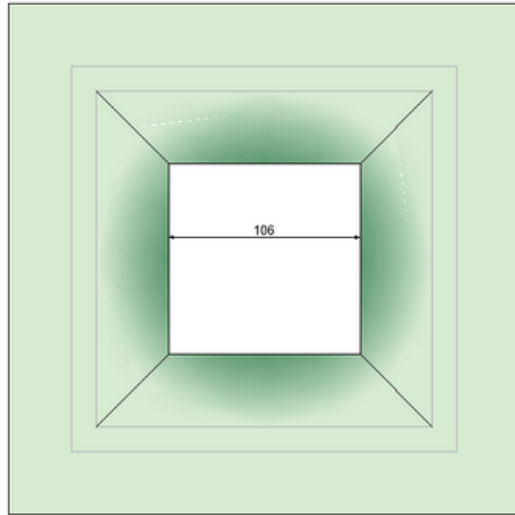

284

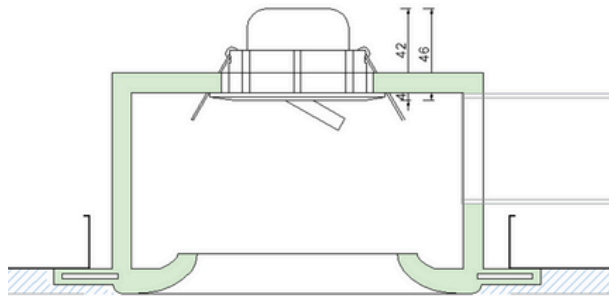

100

244

AirGlow Reno connection

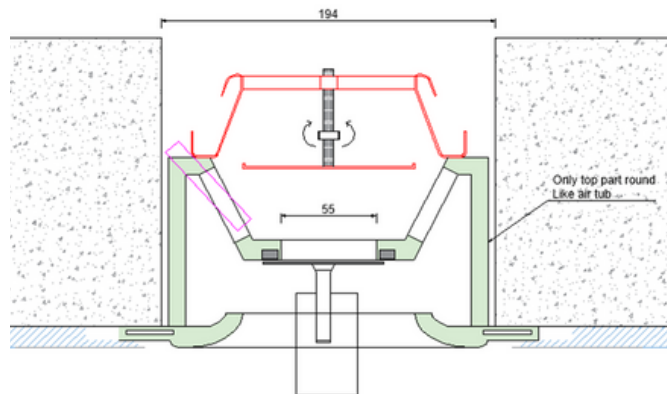

194

55

Only top part round
Like air tub

100

244

AirGlow New connection

AirGlow Round

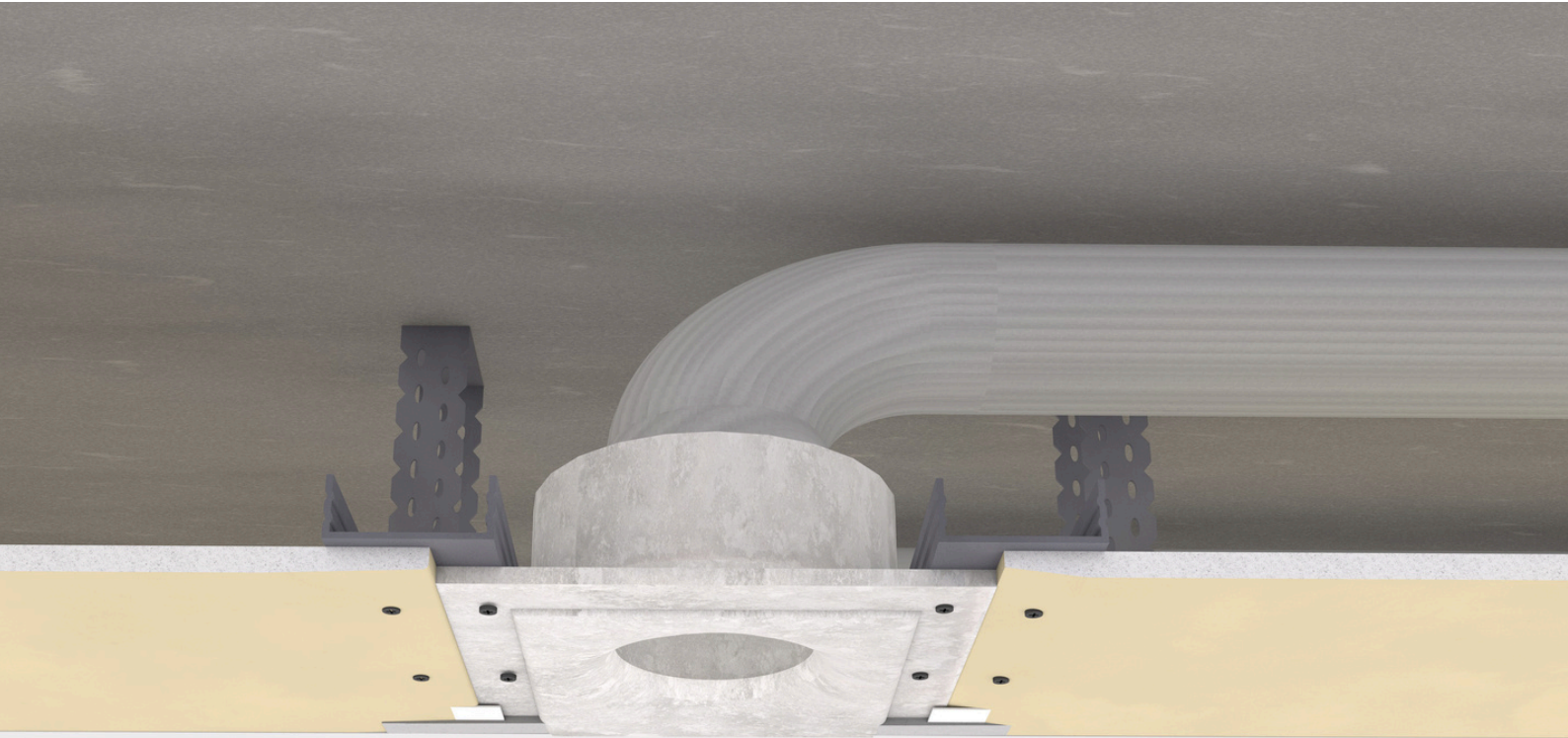

Meet the Airglow ROUND, a round lighting fixture that integrates invisible ventilation. This design offers an elegant solution, eliminating the need for ceiling vents.

The Airglow ROUND provides both optimal lighting and air circulation, and maintains a sleek, aesthetic appearance. Ideal for architects and designers who are looking for a combination of style and functionality without making concessions.

The Airglow ROUND is compatible with any type of air duct, including fixed, flexible air duct or valve collectors, ensuring versatility.

We can offer these with accompanying spotlights, ask for more information

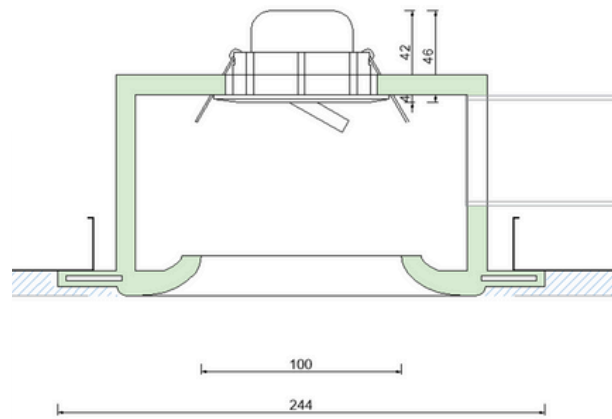
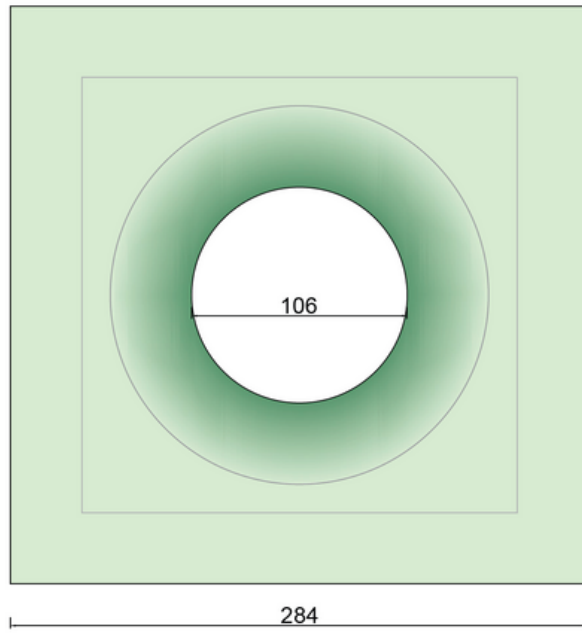

AirGlow Reno connection

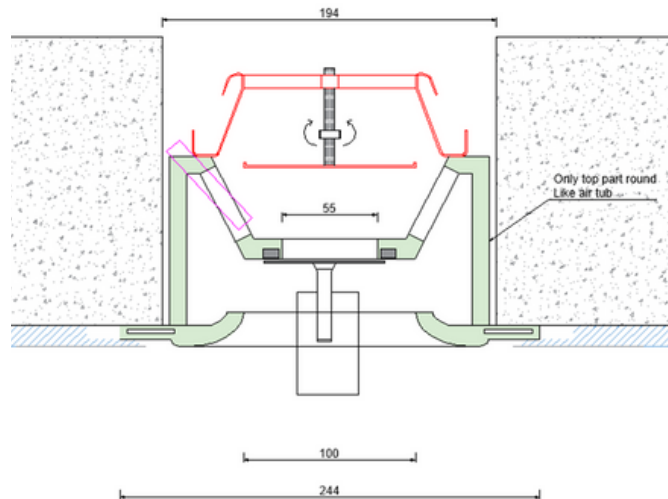

AirGlow New connection

AirGlow Spot



Discover the Airglow SPOT, a lighting solution that offers the same sleek appearance as the Airglow SQUARE and Airglow ROUND, but without a ventilation connection. These spotlights create a uniform and aesthetic overall picture in your ceiling. They are easy to assemble and easy to maintain, making them a practical and stylish choice for any space. Perfect for architects and designers who value simplicity and elegance.

The Airglow SPOT is compatible with any type of air duct, including fixed, flexible air duct or valve collectors, ensuring versatility.

We can offer these with accompanying spotlights, ask for more information

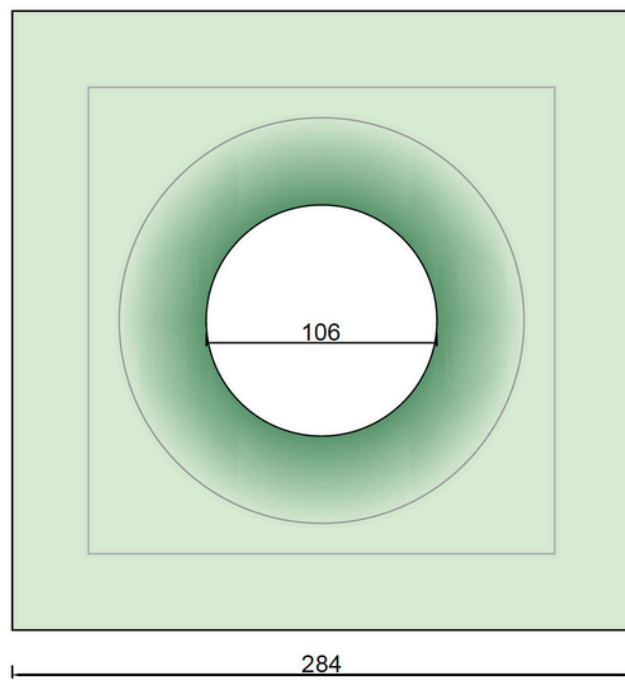
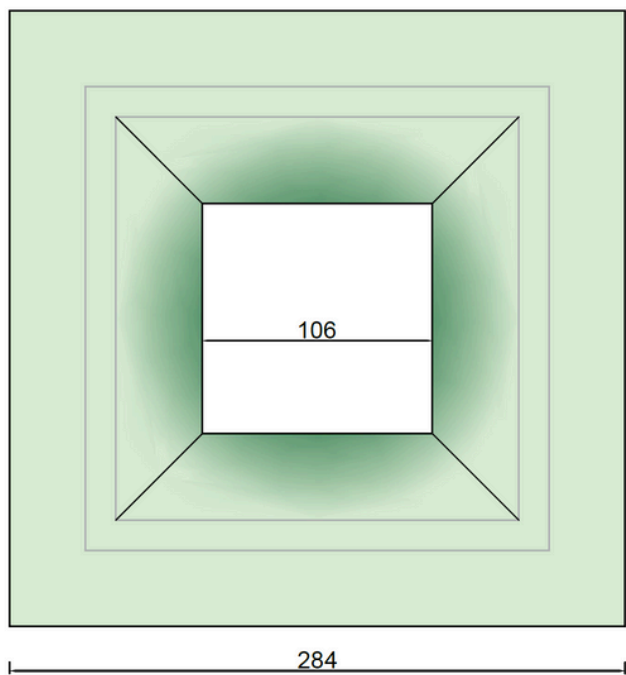
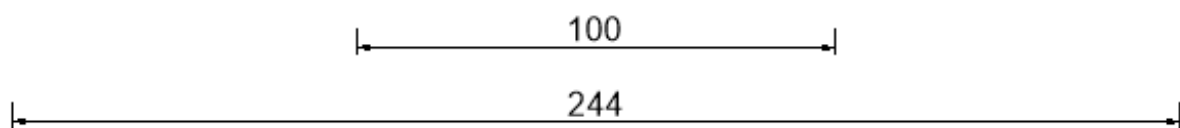
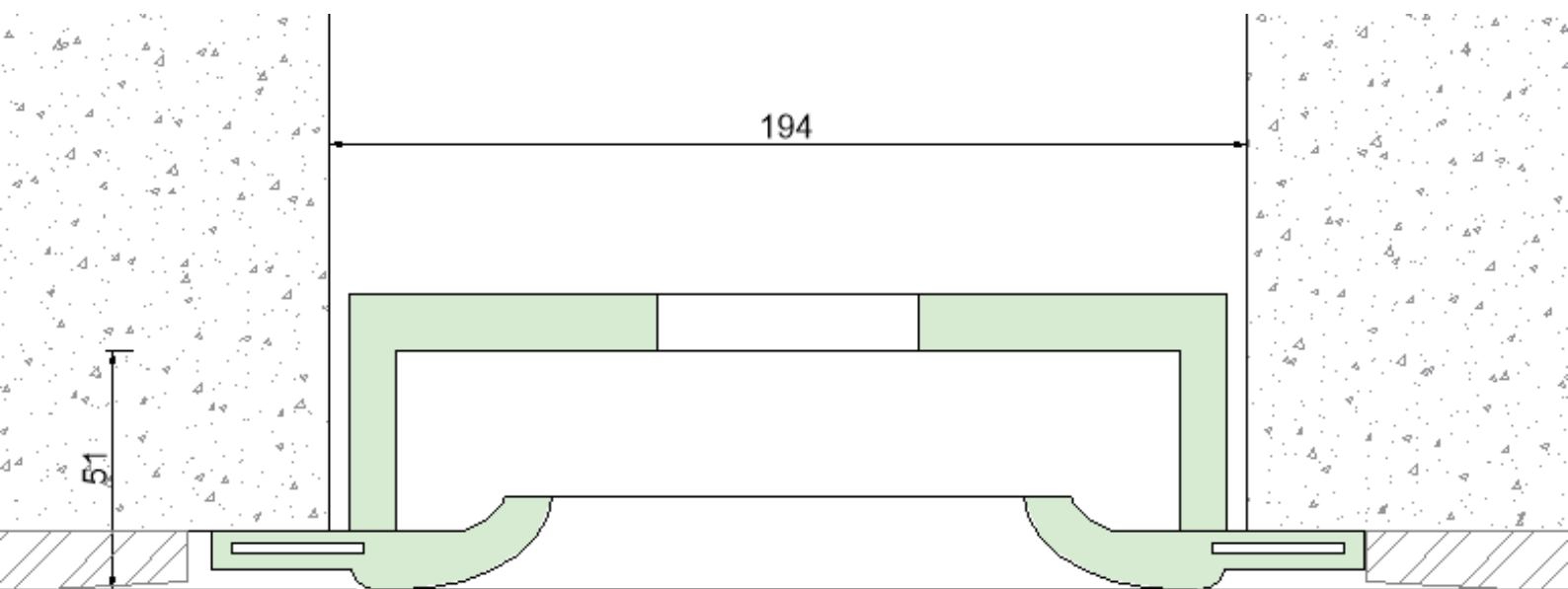

AirGlow Ventilation

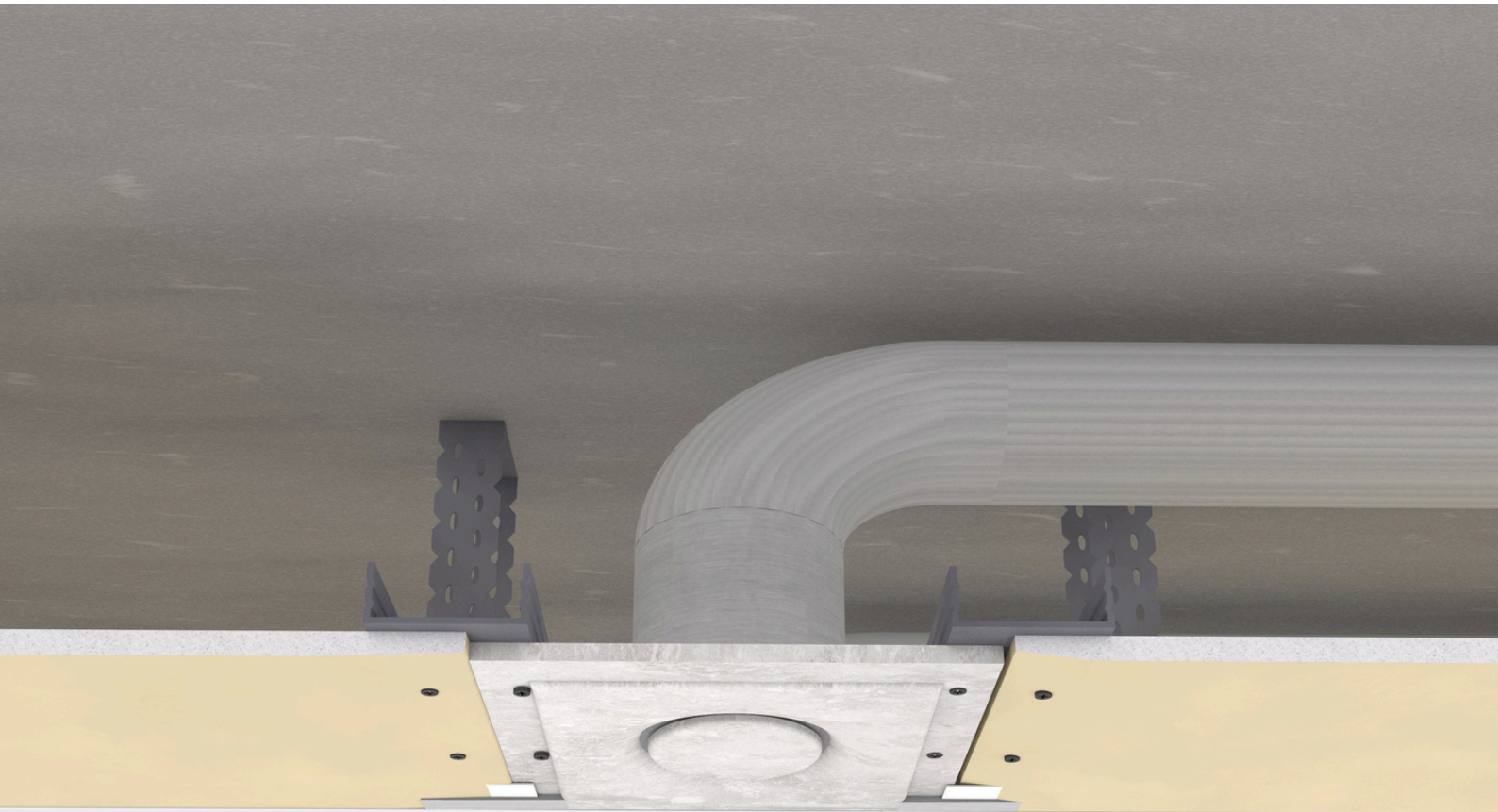

Meet the Airglow VENTILATION, the ideal solution for seamless integration of ventilation into your ceiling. This innovative system ensures that the ventilation nozzle is flush with the finished ceiling height, maintaining the sleek design of your space.

Airglow VENTILATION offers an elegant and functional way to combine optimal air circulation with a refined appearance. Perfect for those who want to effortlessly combine aesthetics and performance.

The Airglow VENTILATION is compatible with any type of air duct, including fixed, flexible air duct or valve collectors, ensuring versatility.

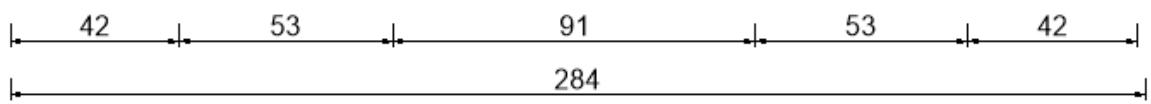
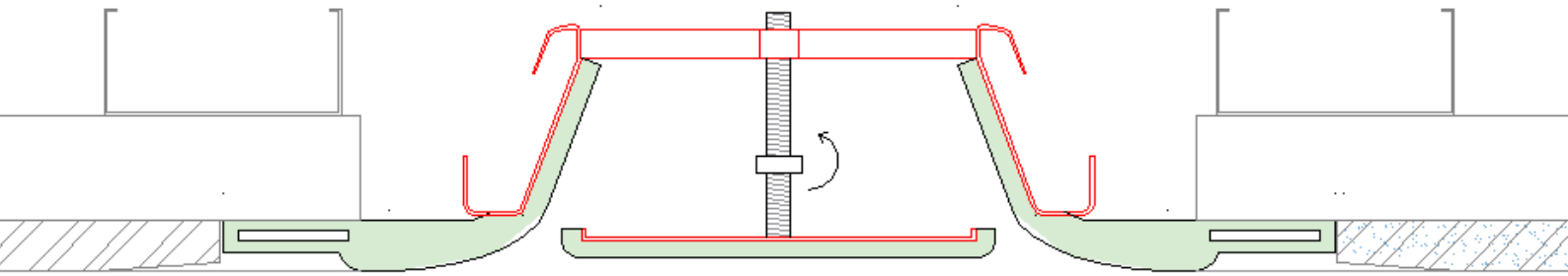

AirGlow Light Track

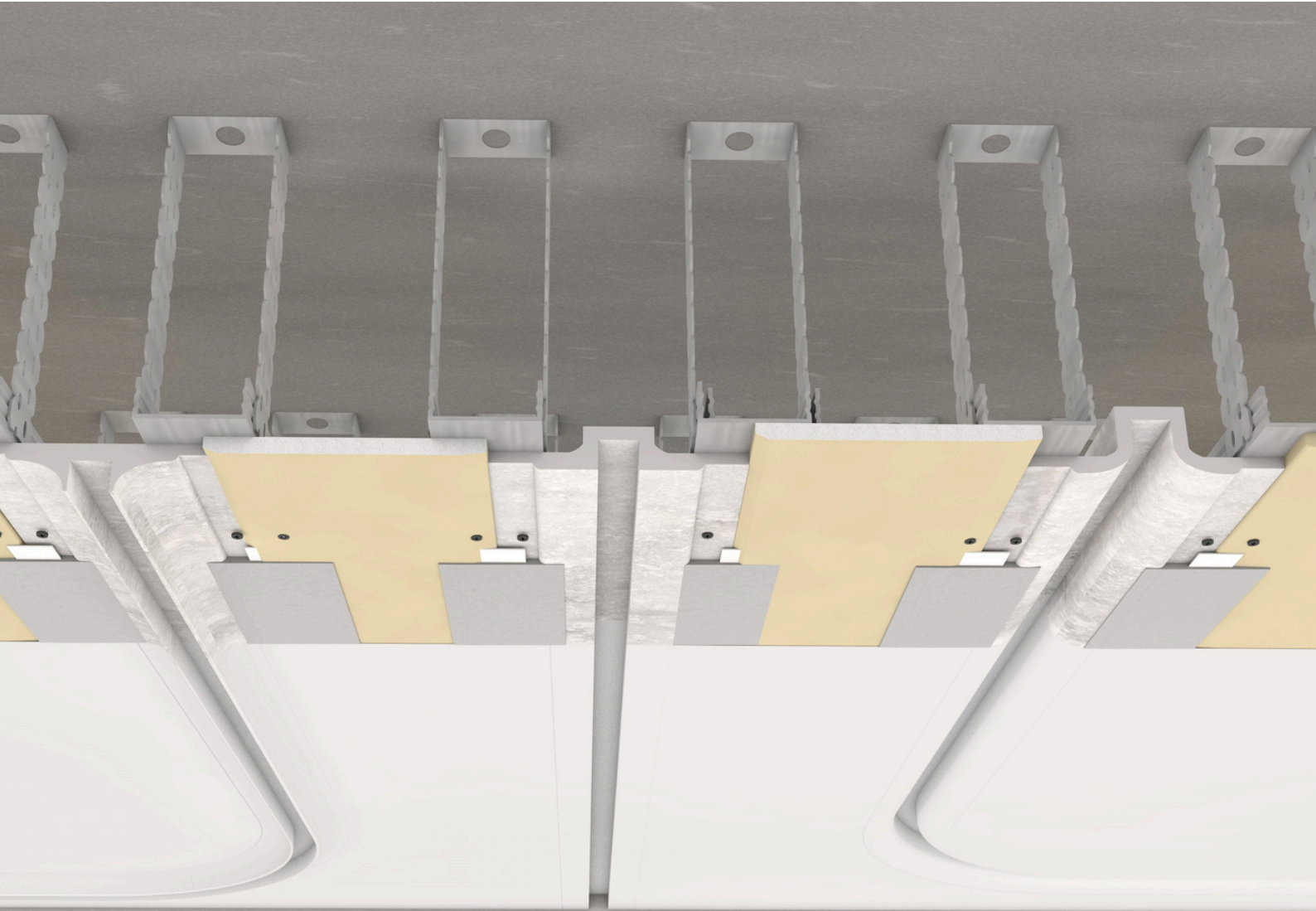

Discover the AirGlow LIGHT TRACK, an advanced system for seamlessly integrating lighting rails. Whether recessed, flush or surface-mounted to the ceiling, this system provides an elegant solution that maintains the aesthetics of your space.

The LIGHT TRACK can be easily mounted without further finishing near the rail, so that the ceiling retains a sleek and neat appearance. Perfect for a modern and refined finish to your lighting system.

We can offer these with accompanying rails and spotlights, ask for more information

Recessed

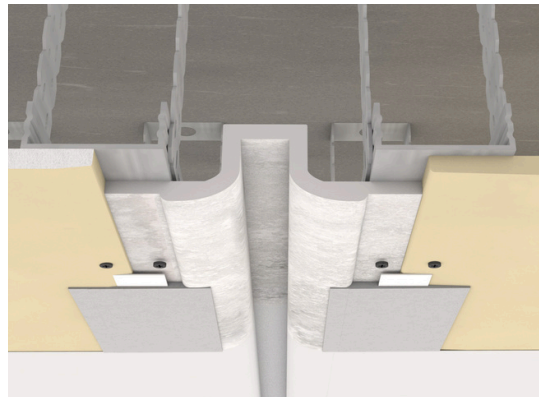
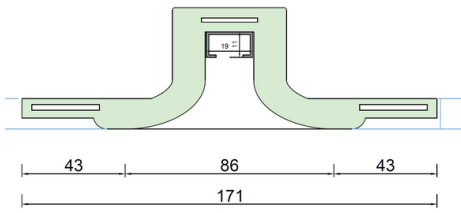

Seamless

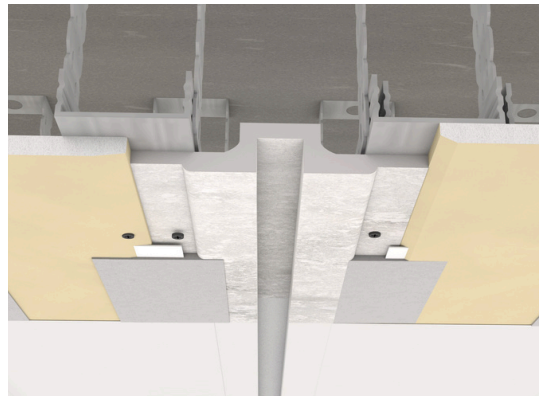
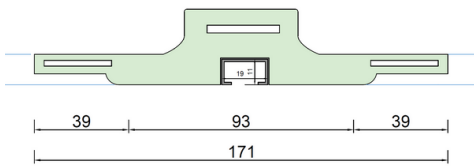

Ornament

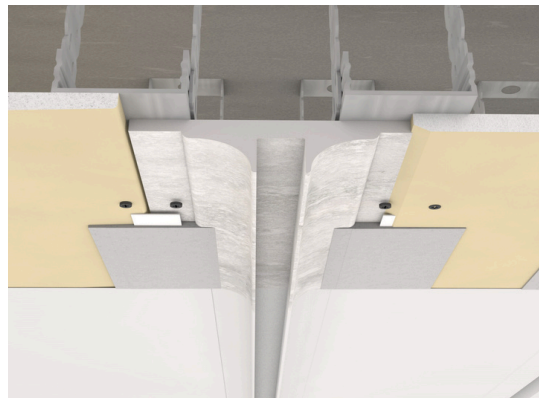
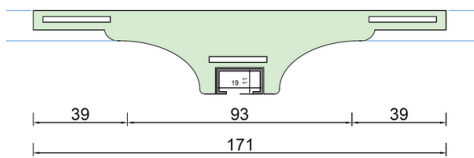

End piece

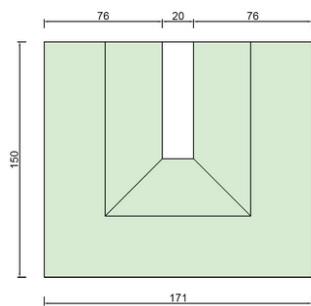

90° Curve

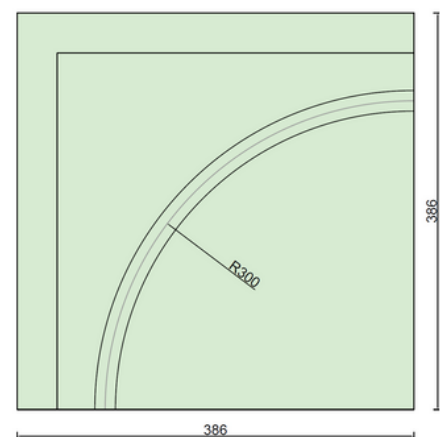

AirGlow Round pendant



Discover the AirGlow ROUND PENDANT, an elegant round lighting element that can be flexibly mounted in or on the ceiling. Available in various diameters, this design offers a modern look and a refined finish for your lighting solutions.

The AirGlow ROUND PENDANT not only adds style to your space, but also provides atmospheric and effective lighting. Perfect for creating a contemporary and sophisticated ambiance.

We can offer these with accompanying LED strips and spotlights, ask for more information

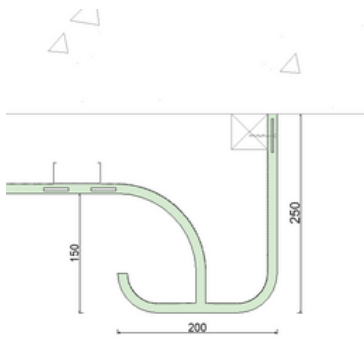
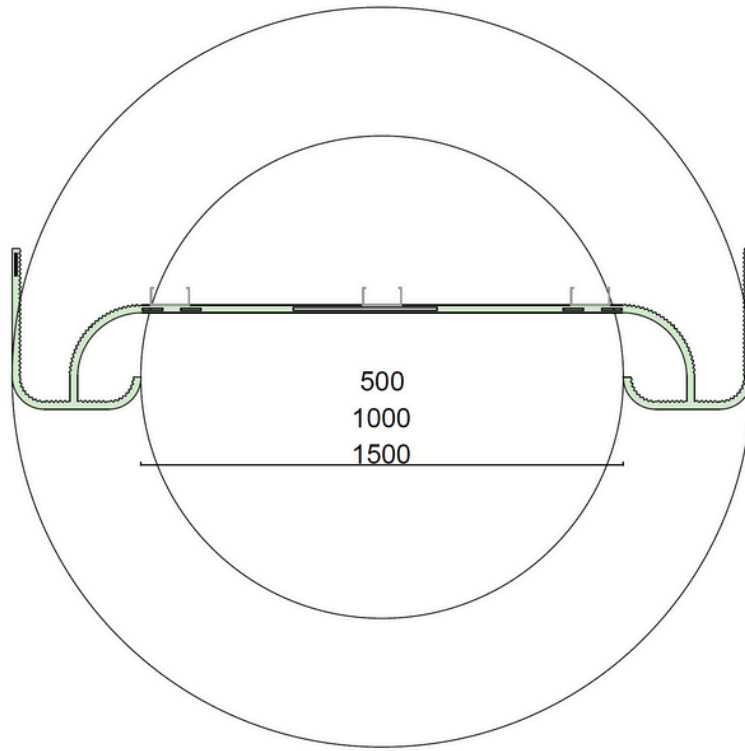

Ceiling mounted

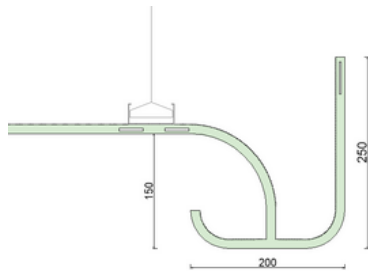

Pendant mounting

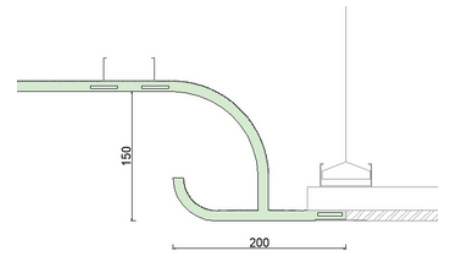

Recessed - seamless



AirGlow Oval pendant



Discover the AirGlow OVAL PENDANT, the elegant oval version of our Round Pendant. This refined lighting fixture can be mounted in or on the ceiling and is available in various sizes.

The AirGlow OVAL PENDANT offers a modern and sophisticated look that transforms any space. With its unique oval shape, it provides even and atmospheric lighting, perfect for creating a stylish ambiance in your interior.

We can offer these with accompanying LED strips and spotlights, ask for more information

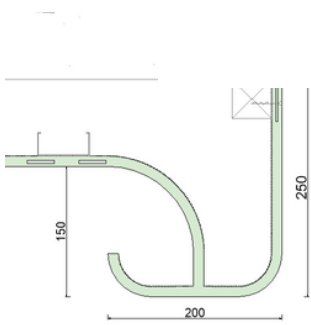
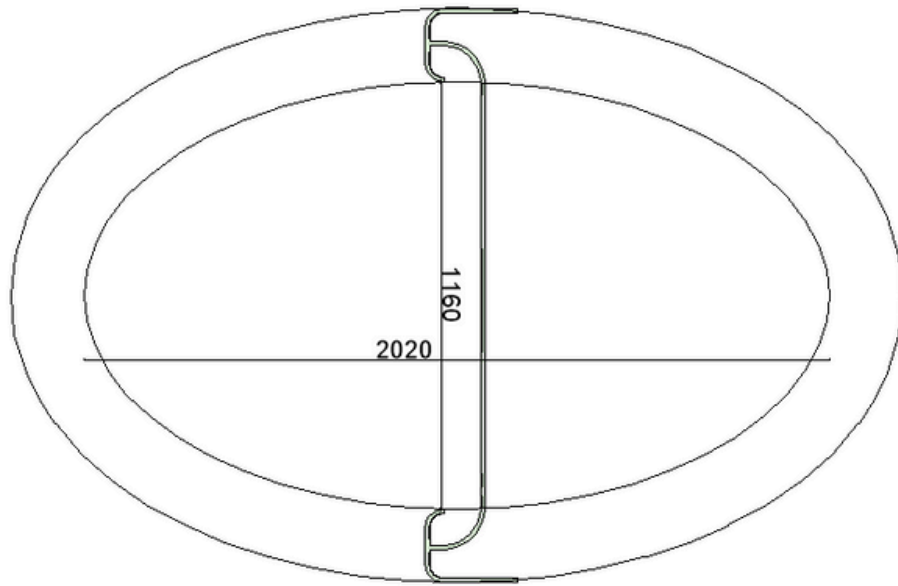

Ceiling mounted

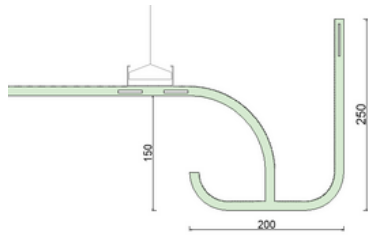

Pendant mounting

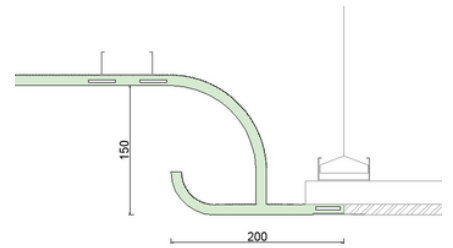

Recessed - seamless

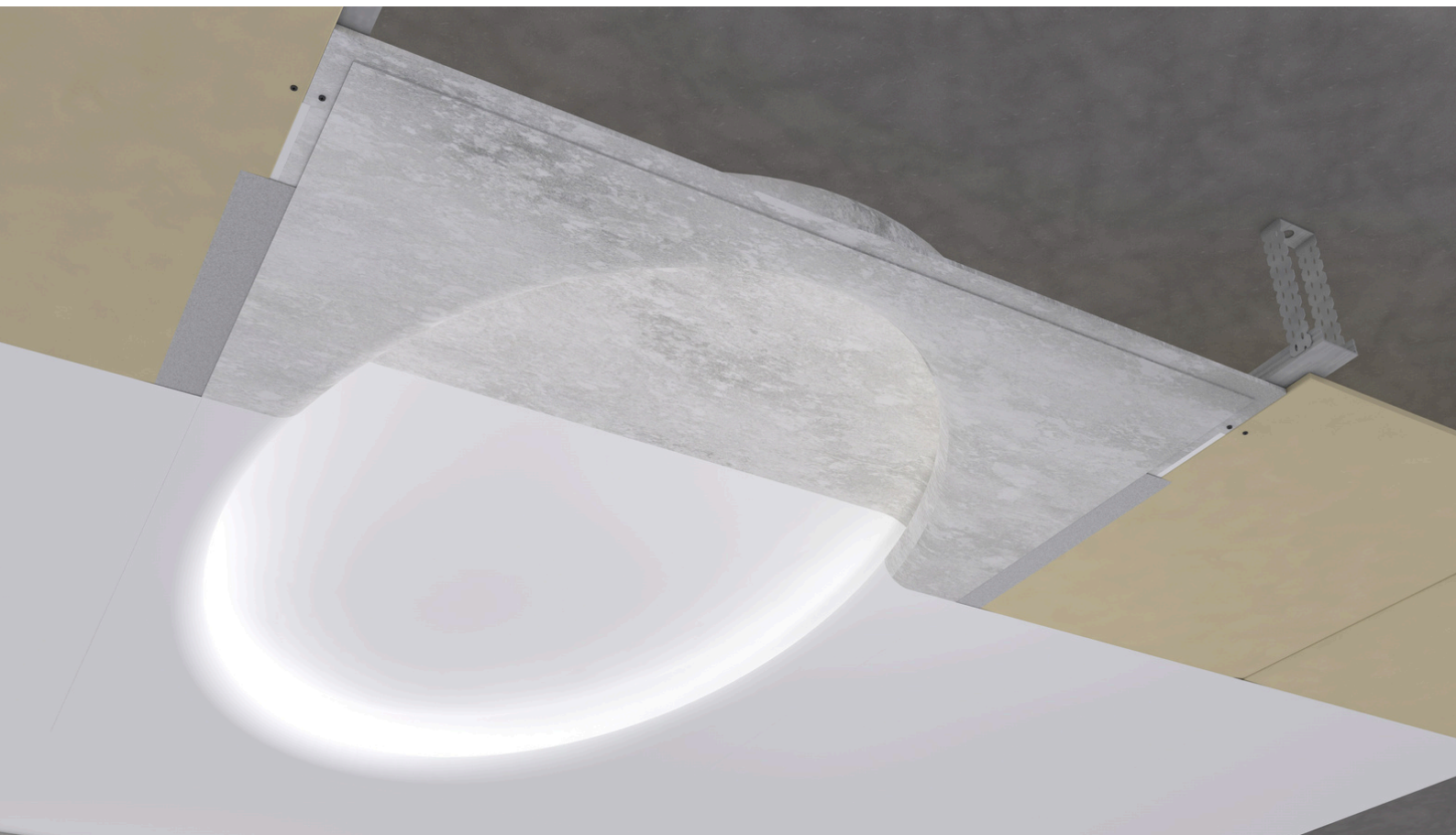

4

Customization

The solution for your imagination

Imagine a world where your most unique visions become reality. Welcome to the land of Gyrex, the undisputed master of customization for one-off projects and products. Here, in this limitless domain, there are no limitations. Everything you can imagine can be transformed into tangible shapes and structures, like a wondrous dance between your imagination and our skilled hands.



INSTALLATION BENEFITS

Choose carefree and fast installation with our prefab elements and lightweight material. With finishes such as plasterboard seams you create a strong, seamless whole of unprecedented quality.





Mastercard
Brussels
Aftiplan



European Parliament
Brussels
ASSAR Architects





Shop
Amsterdam



Royal Golf Club
Waterloo



**Corinthia Grand Hotel Astoria
Brussels**





Shopping center
Weide

Cotton Club

Cotton Club
Leiden





Link 21 - Restaurant
Herentals

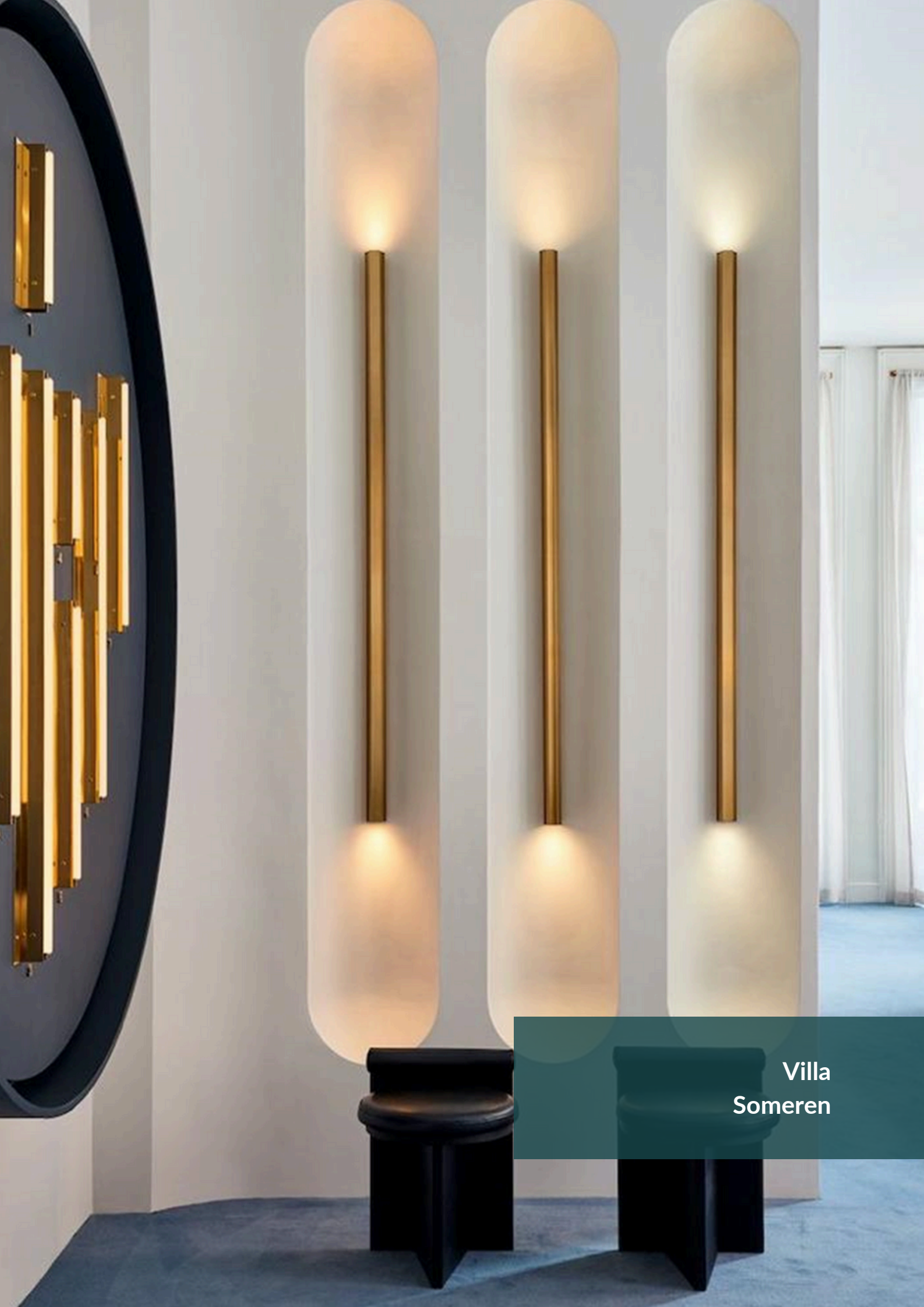

Villa
Someren

5

Assembly Instructions

1. Preparation

- Ensure that the underlying wall or ceiling structure is suitable for supporting the Gyrex elements.
- Check that the elements are equipped with an AK/ABA edge, which allows for attachment with drywall screws that have a drill point.



2. Installation of Individual Elements

- Place the Gyrex element against the underlying structure, with the AK/ABA edge facing forward.
- Use drywall screws with a drill point to securely fasten the element. Ensure that the screws penetrate sufficiently deep into the structure for a stable attachment.

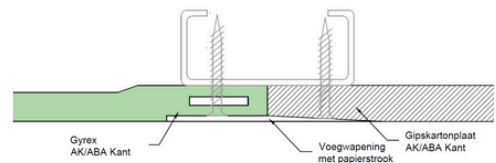

3. Installation of Elements with Male-Female System:

- If the elements have a male-female system, ensure that the male
- Secure the elements to each other by fastening drywall screws into the overlapping AK/ABA edges.

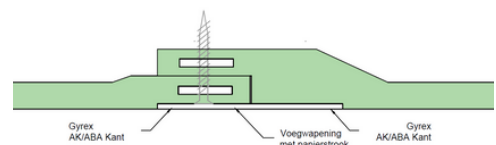

4. Additional Instructions:

- After installation, check that all Gyrex elements are securely and correctly attached.
- Always follow the guidelines and regulations from Gyrex for optimal installation and performance of the systems.

Finishing of Joints

1. Finishing Gyrex Elements in Drywall Wall and Ceiling Systems

The strength of Gyrex lies in creating seamlessly integrated, reinforced elements in drywall walls and ceilings. This document provides the proper processing instructions to achieve a truly seamless transition with Gyrex elements in drywall walls and ceilings.

1.1. General

There are various types of these joint connections, each with its own method. A few general guidelines apply to all variants:

- The joint connections between Gyrex and drywall panels must always be finished with joint compound.
- These joints must also always be reinforced. Self-adhesive mesh tape is unsuitable as reinforcement in this application. Use paper joint tape instead.
- The paper tape should be embedded in the joint compound, ensuring that sufficient material is under the reinforcement tape. Ideally, the reinforcement tape lies as close as possible to the joint surface.
- It may be necessary to sand the cured and dried joint products between and after operations. It is preferable to use sanding mesh with a grit of 180.

1.2. Joint Variants

1.2.1 Gyrex Beveled Edge Against a Standard Beveled Edge (ABA/AK)

- The edges are fitted against each other.
- This joint can be directly filled with joint compound, embedding the paper tape in the wet compound.
- After drying, the joint should be finished with a standard finishing product.

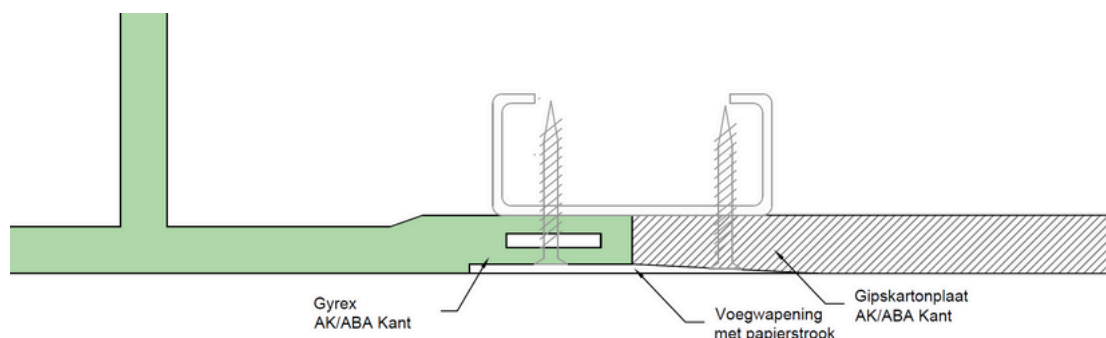

1.2.1 Gyrex Beveled Edge Against a Sawed or Cut Edge

- Straight edges, cut edges, and sawed edges should be provided with a beveled edge before installation.
- The Gyrex edge and drywall edge are fitted against each other.
- Next, these edges are filled with joint compound, and a thin layer is applied to the panel surface on both sides of the joint. The reinforcement tape is then lightly pressed into the compound with a joint knife, taking care not to push the compound away from under the tape. Following this, the joint tape is thinly covered with compound to embed it.
- After drying, the joint should be leveled as wide as possible with a finishing joint product.

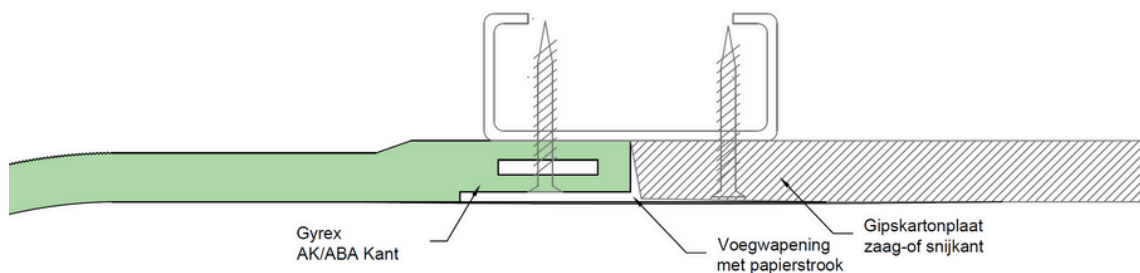

1.2.1 Gyrex Beveled Edge Against Gyrex Beveled Edge

- The Gyrex edges are fitted against each other.
- These beveled edges are filled with joint compound on both sides of the joint. The paper joint tape is then lightly pressed into the compound with a joint knife, taking care not to push the compound away from under the tape. Following this, the joint tape is thinly covered with compound to embed it.
- After drying, the joint should be leveled as wide as possible with a finishing joint product.

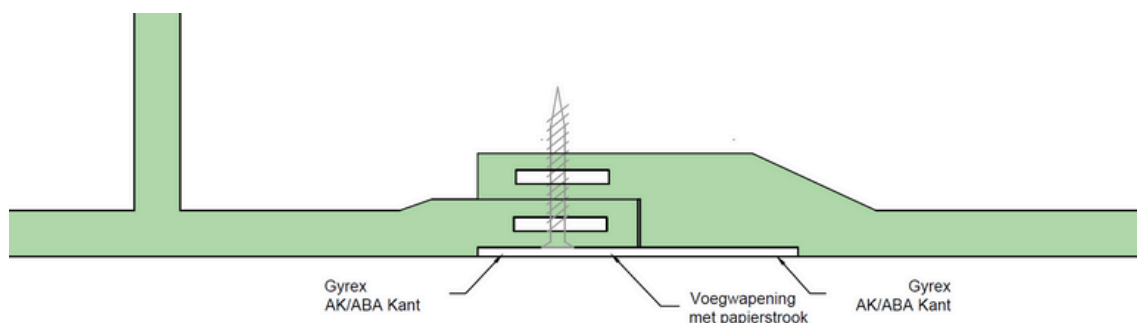

6

Specification text

1. Glass Reinforced Composite - GRG

1.1. General

Glass Reinforced Composite (GRG) is a white 'thin shell' alpha plaster reinforced with fiberglass mats. Because of its light weight, strength and finish, it can be used in interior finishing.

1.2. Compound

1.2.1 Alpha plaster

Alpha plaster is made entirely of Calcium (II) sulfate Hemi hydrate (CaSO₄.1/2 H₂O) alpha plaster with an addition of a curing additive. The composition can be formulated as follows:

- Calcium (II) sulfate Hemi hydrate (CaSO₄.1/2H₂O) : 99.98%
- Patented inorganic additive : 0.02%

1.2.2 Fiberglass Mats

E-glass mat on a roll consisting of randomly oriented fibers in several layers composed with a suitable binder and silane coupling agent.

The E-glass fiber combines the electrical and mechanical properties of traditional E-glass with the acid corrosion resistance of E-CR glass.⁷

1.2.2.1 Fiberglass mat specification

Dimensionering	Binder type	Oplosbaarheid in styreen	Lineaire gewicht van fundamentele onderdelen (tex)	Hechtingsverlies %	Vochtgehalte %	Gewicht Kg/m ²
Sylane	Polyester	Laag	25	6	< 0.15	0.3

1.3 Performance Requirements

The product is generally 7mm. thick, except for parts that require more durability. The final product has a nominal weight of 7-9 kg/m² and a Rockwell hardness of M72.

Gyrex GRG with regard to its reaction to fire behavior achieves the following classification:

A1 according to standard EN13501-1:2018 – report number 20858e EN13501-1

A2-S1-D0 according to standard EN13501-1:2018 – report number 20858C EN13501-1 On substrate

G.R.G. is generally supplied as a painter-ready product (the natural color of the product ranges from white to grey-white with a visible fiberglass pattern). Unevenness, screw holes still need to be finished and sanded. G.R.G. is subject to water damage if constantly placed in a very wet place. It is recommended to use a relatively dry place to avoid damage.

1.3.1 Tolerances

The final dimensions of the finished G.R.G. product should be such that when installed, all dimensions meet the following permissible criteria or architectural requirements:

- For a total length and height of maximum 3 meters, the deviation may only be ± 3 mm per m1.
- The edges show a deviation of ± 3 mm. and the evenness, i.e. the deviation over 1 meter of straight edge line placed at any point on a slab, should show a smooth surface with deviation understood to be around ± 3 mm.
- Squareness of corners: it concerns the difference between the work performed compared to the prescribed angles (reveals, fireplaces, ...), which can be straight or oblique. The predetermined angle may not differ from the design by more than 5° .

Important: A finished surface should never be produced under glancing light or backlighting. According to the rules of the art, delivery takes place in daylight, with the naked eye and from a distance of 2 m, perpendicular to the surface to be checked. All control methods that deviate from this are not allowed.

1.4 Installation

Given the special aspect of each individual product, fewer structures will be required for a G.R.G. installation than with conventional systems for installing gypsum panels and other materials.

G.R.G. usually installed on lightweight components placed around plasterboard ceilings.

These components can be used for both vertical and horizontal surfaces and this is therefore the most efficient way of working. If necessary, due to a special design, a second more solid steelwork can be placed first.

The ceiling parts are suspended by sprung quick hangers. The maximum intermediate distance is 1200 mm, connection quick hanger and GRG element is done by a bound metal ceiling profile.

The interconnection of two GRG elements is always done by vulcanization along the non-visible side and the eruption along the visible side is removed with a spatula. All screw holes and gaskets are filled with the same plaster mixture used in the production process. Traditional sealants can also be used for this.

G.R.G. is installed using traditional gantry systems and, if weight is a factor, standard lifting equipment can always be used.

G.R.G. can be cut either with a handsaw, with an angle grinder with diamond or metal blades or with a jigsaw, so only standard hand tools are required for installation purposes.

AIRGLOW designed by Gyrex

Vaartkant Rechts 8G
B-2960 Brecht
airglow@gyrex.be

Kristof Monsieurs
+32 474 78 75 17